

HUNTERS®

HERE TO GET *you* THERE



Southwell Road

SE5 9PG

£2,000 Per Calendar Month



Spacious top floor two double bedroom period conversion.

Situated on the top floor of a Victorian house conversion this well proportioned property benefits from two good sized double bedrooms, spacious separate reception, modern fitted kitchen diner and contemporary bathroom. with both bath and shower fitting.

Tucked away on a quiet residential street in the heart of Zone 2 central London a short walk to Kings College hospital, Denmark Hill overland station with easy access to the West End & City. A vast range of bars, restaurants and local amenities that this ever popular area has to offer nearby.

Brixton with its vibrant entertainment scene is a short bus ride away.



Area Map

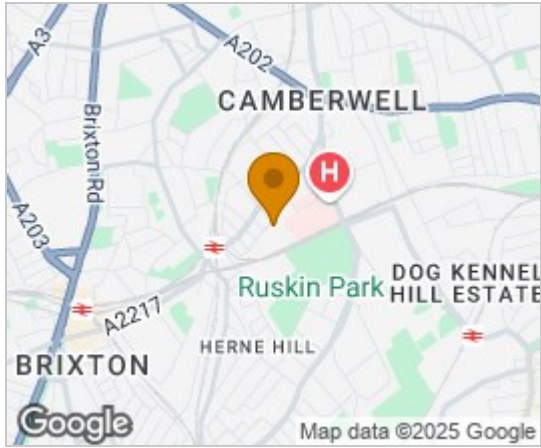

Floor Plans

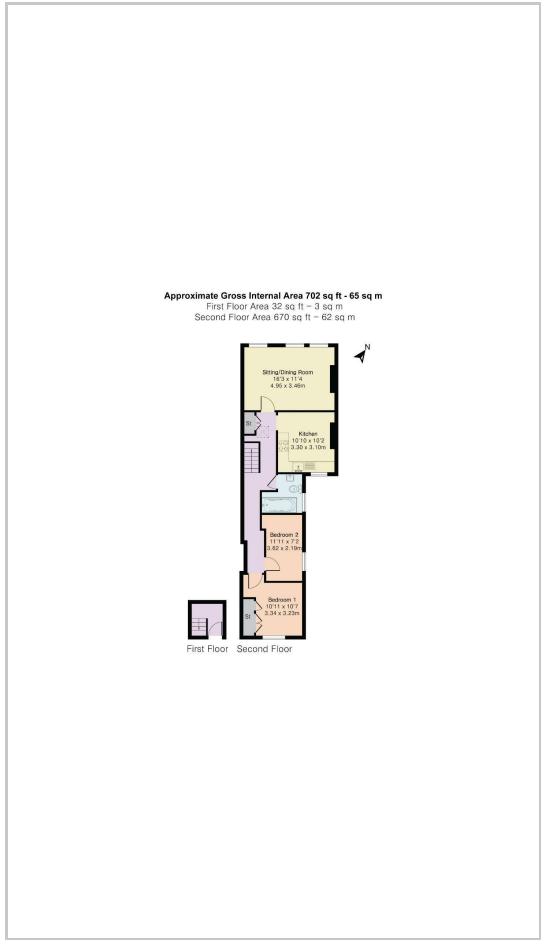

Energy Efficiency Graph

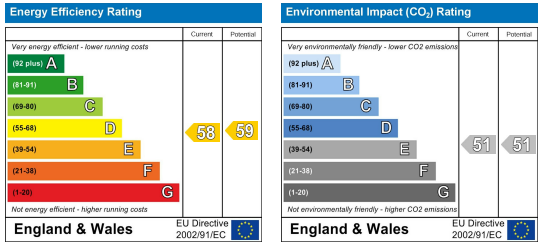

These particulars are intended to give a fair and reliable description of the property but no responsibility for any inaccuracy or error can be accepted and do not constitute an offer or contract. We have not tested any services or appliances (including central heating if fitted) referred to in these particulars and the purchasers are advised to satisfy themselves as to the working order and condition. If a property is unoccupied at any time there may be reconnection charges for any switched off/disconnected or drained services or appliances - All measurements are approximate. **THINKING OF SELLING?** If you are thinking of selling your home or just curious to discover the value of your property, Hunters would be pleased to provide free, no obligation sales and marketing advice. Even if your home is outside the area covered by our local offices we can arrange a Market Appraisal through our national network of Hunters estate agents.